

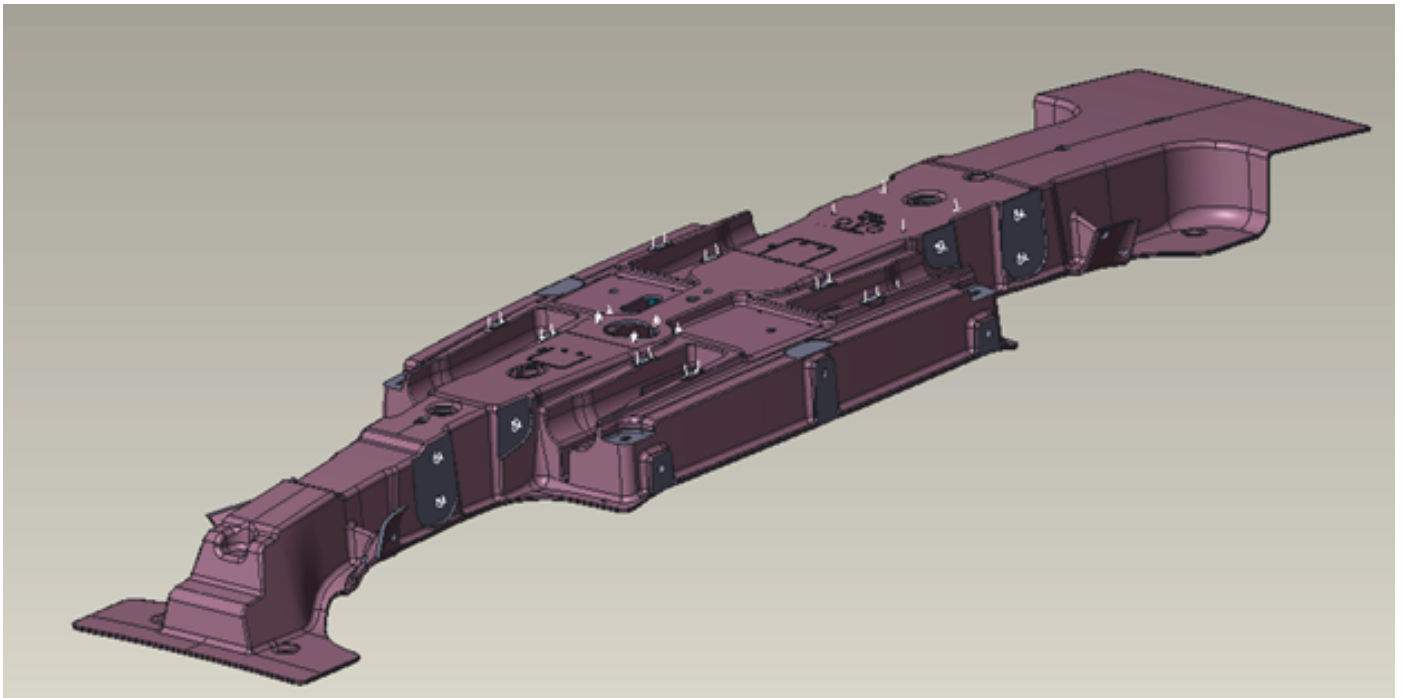

# Tesla Model X Spine Holding System Users Manual

**IMPORTANT** Always refer to OEM repair procedures for proper repair guidelines. Never subject Tesla Model X to pulling forces.



## CHIEF'S LIMITED ONE-YEAR WARRANTY & LIABILITY

Chief Automotive Technologies warrants for one year from the date of installation and/or purchase any of its products which do not perform satisfactorily due to defect caused by faulty material or workmanship. Chief's obligation under this warranty is limited to the repair or replacement of products which are defective and which have not been misused, carelessly handled, or defaced by repairs made or attempted by others.

CHIEF AUTOMOTIVE TECHNOLOGIES DOES NOT ASSUME RESPONSIBILITY FOR ANY DEATH, INJURY OR PROPERTY DAMAGE RESULTING FROM THE OPERATOR'S NEGLIGENCE OR MISUSE OF THIS PRODUCT OR ITS ATTACHMENTS. CHIEF MAKES NO WRITTEN, EXPRESS OR IMPLIED WARRANTY WHATSOEVER OF MERCHANTABILITY OR FITNESS FOR A PARTICULAR PURPOSE OR OTHERWISE REGARDING THE EQUIPMENT OR ANY PART OF THE PRODUCT OTHER THAN THE LIMITED ONE-YEAR WARRANTY STATED ABOVE.

This users manual is designed to assist operators with the safe and efficient use of the Chief Model X Spine Holding System. When used with Chief Electronic Measuring, the system provides operators with the ability to accurately and securely hold replacement parts during vehicle repair.

### **IMPORTANT:**

This manual only identifies basic usage procedures for the Model X Spine Holding System, it must be used with the Chief Spine Holding System.

The Chief Model X Spine Holding System is designed for the holding and positioning replacement parts. It is not designed as a replacement for Chief Anchoring. **IMPORTANT** The Model X Spine Holding System must not be subjected to pulling forces.

Because Chief Model X Spine Holding System works with Chief electronic measuring, special attention should be given to the replacement of the Spine Holding fixtures during setup. Best results will be achieved with the stands located on the perimeter of the vehicle being repaired to prevent shading of measuring targets.

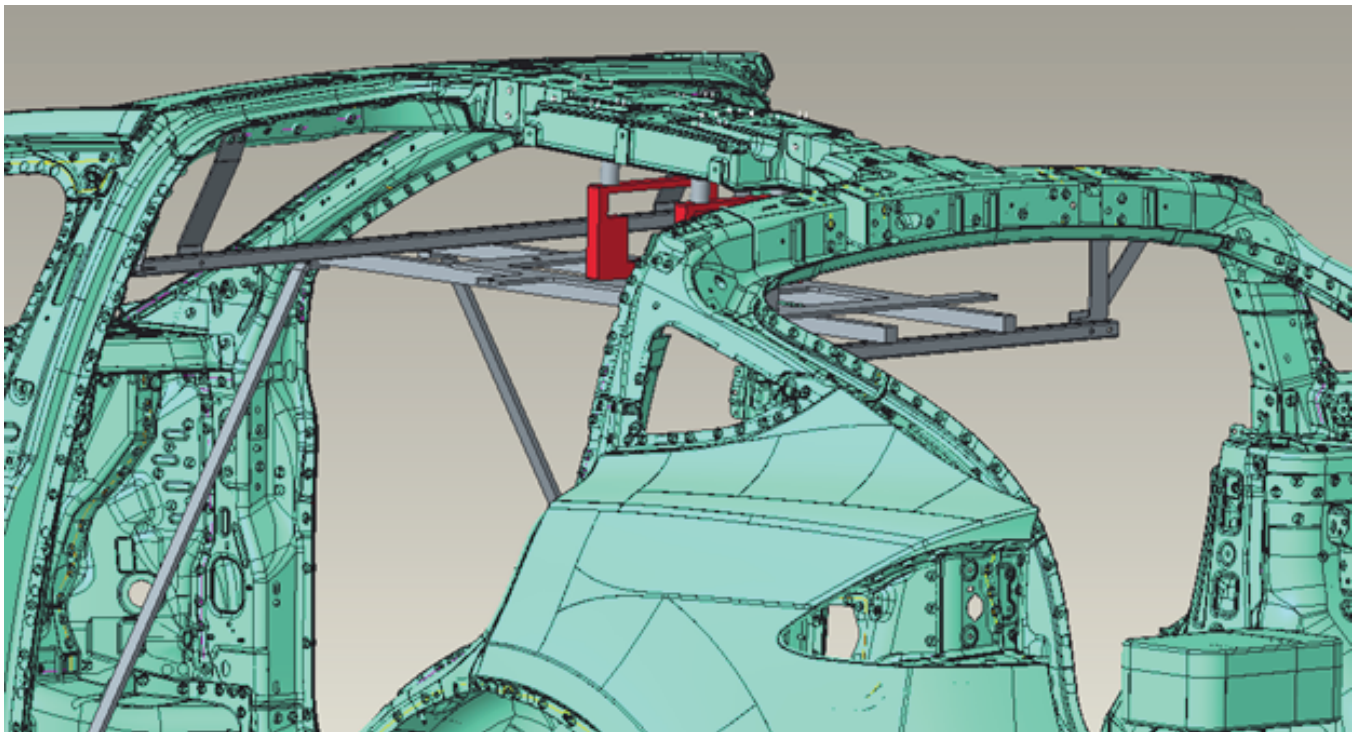
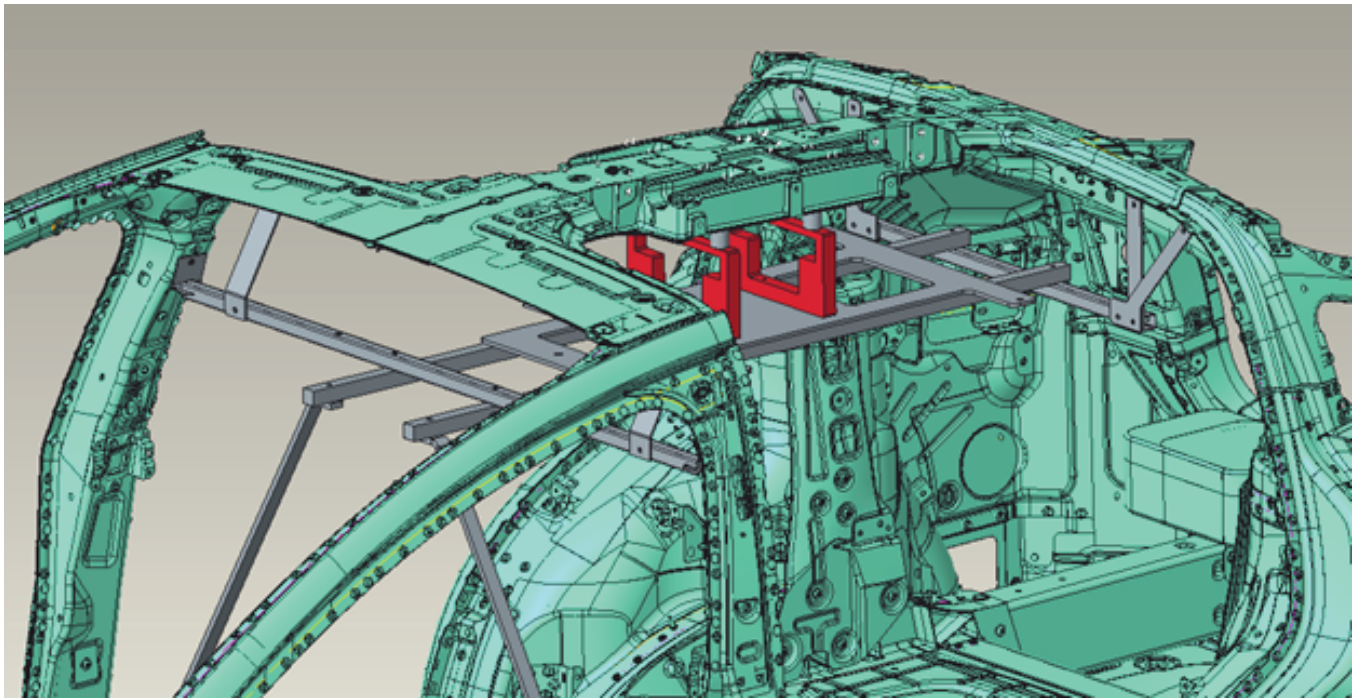



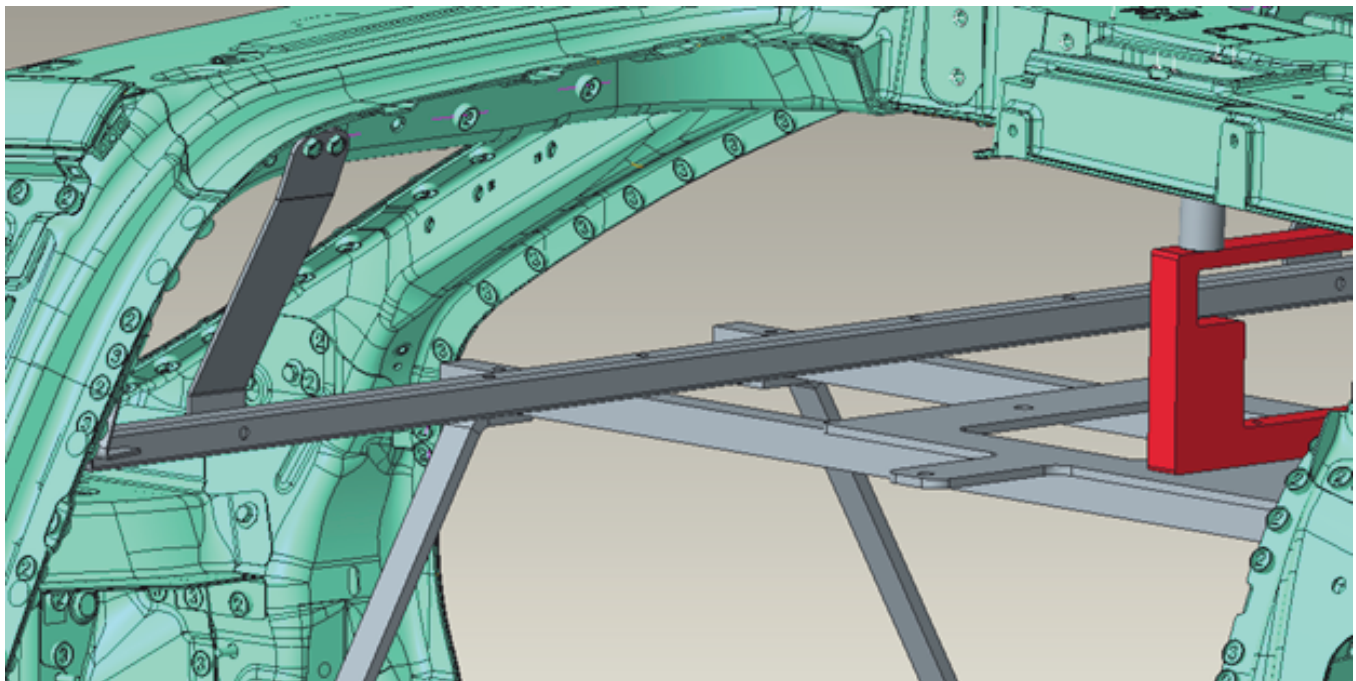
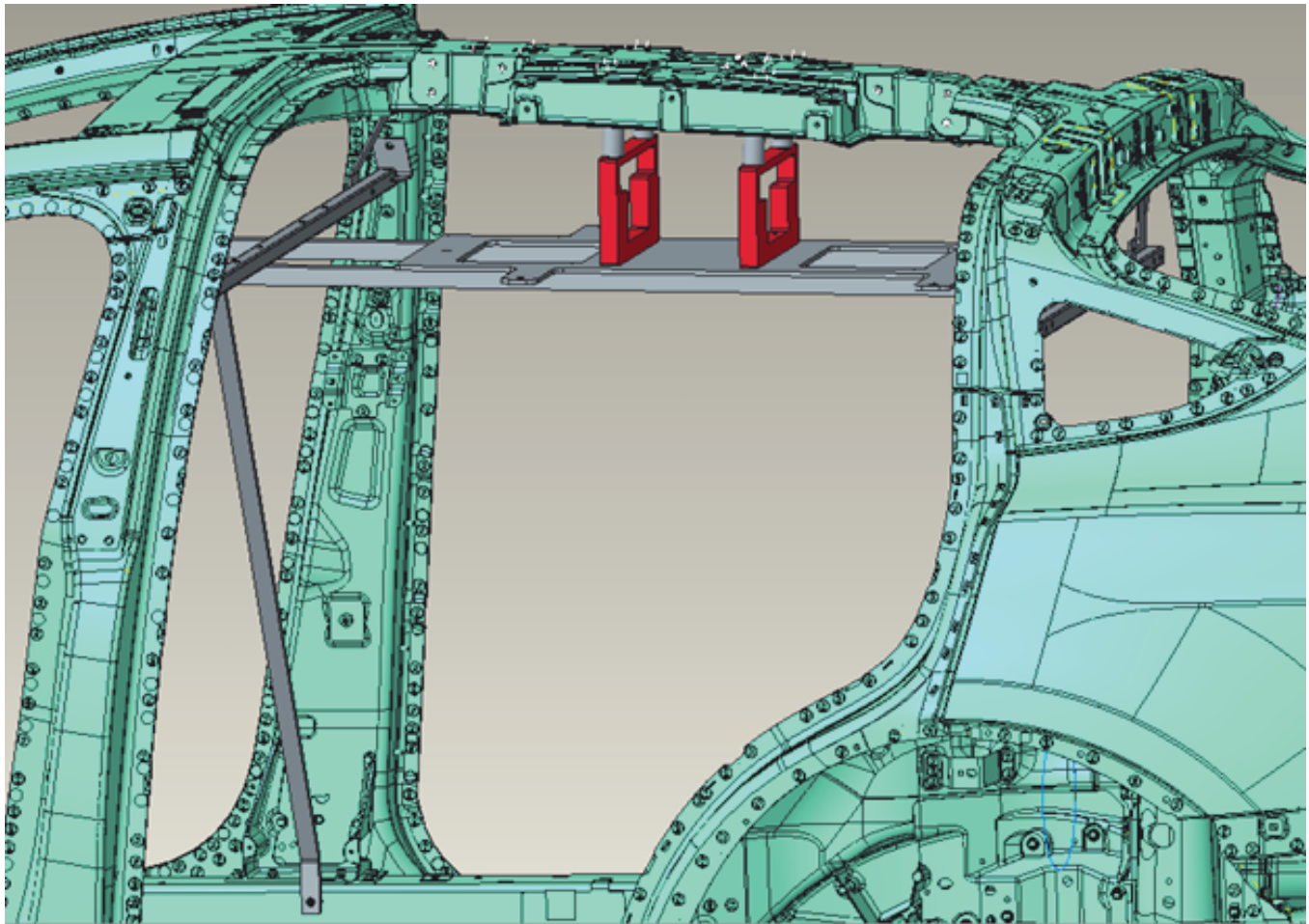

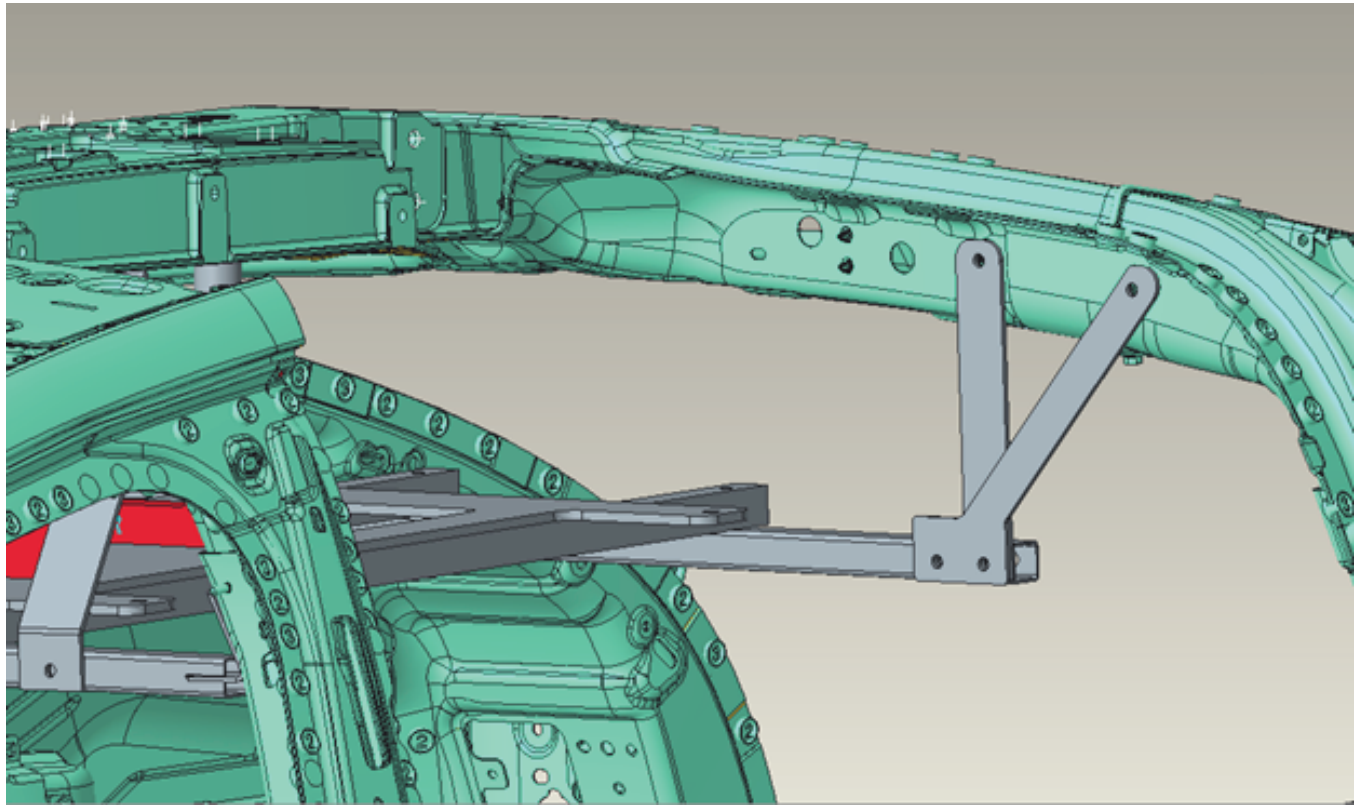

**NOTE:** TAN COVER MUST BE IN PLACE BEFORE INSTALLING FIXTURE.

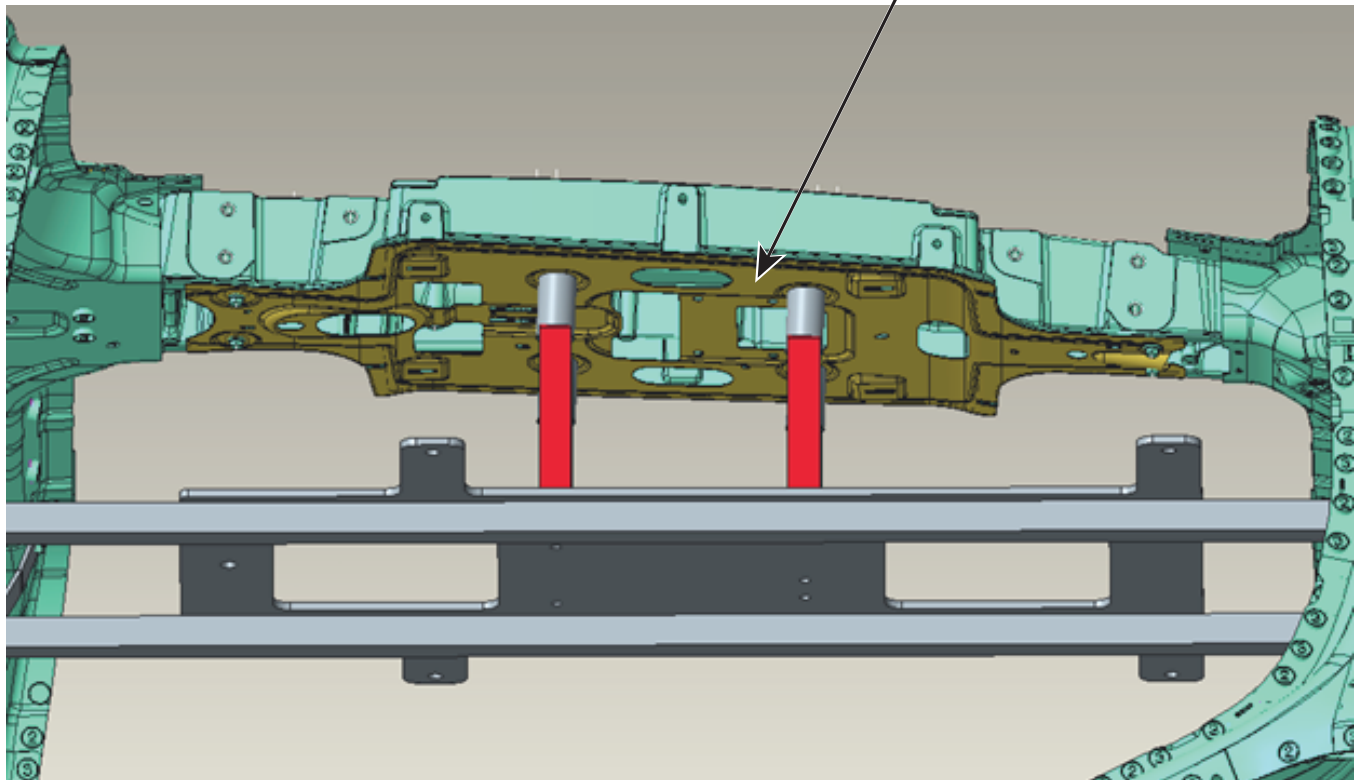

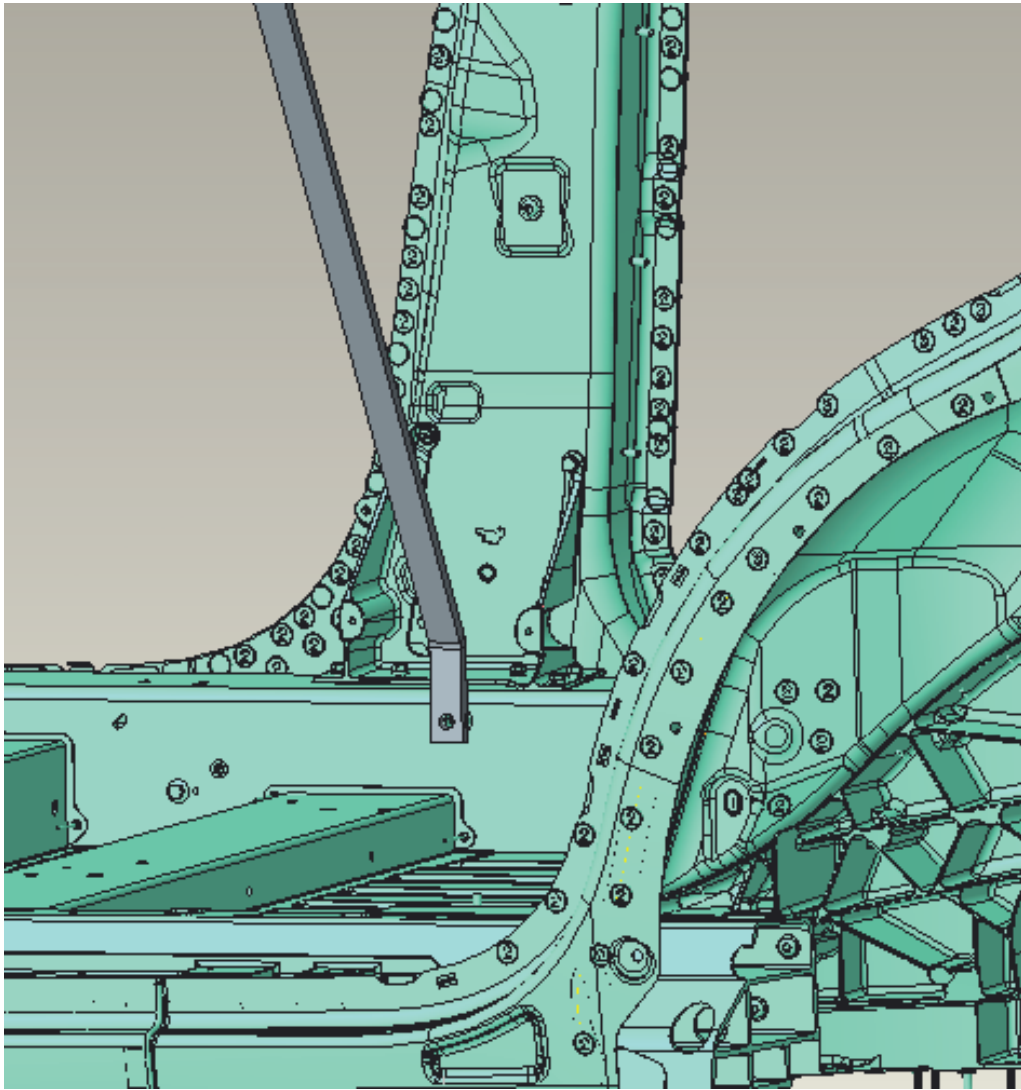

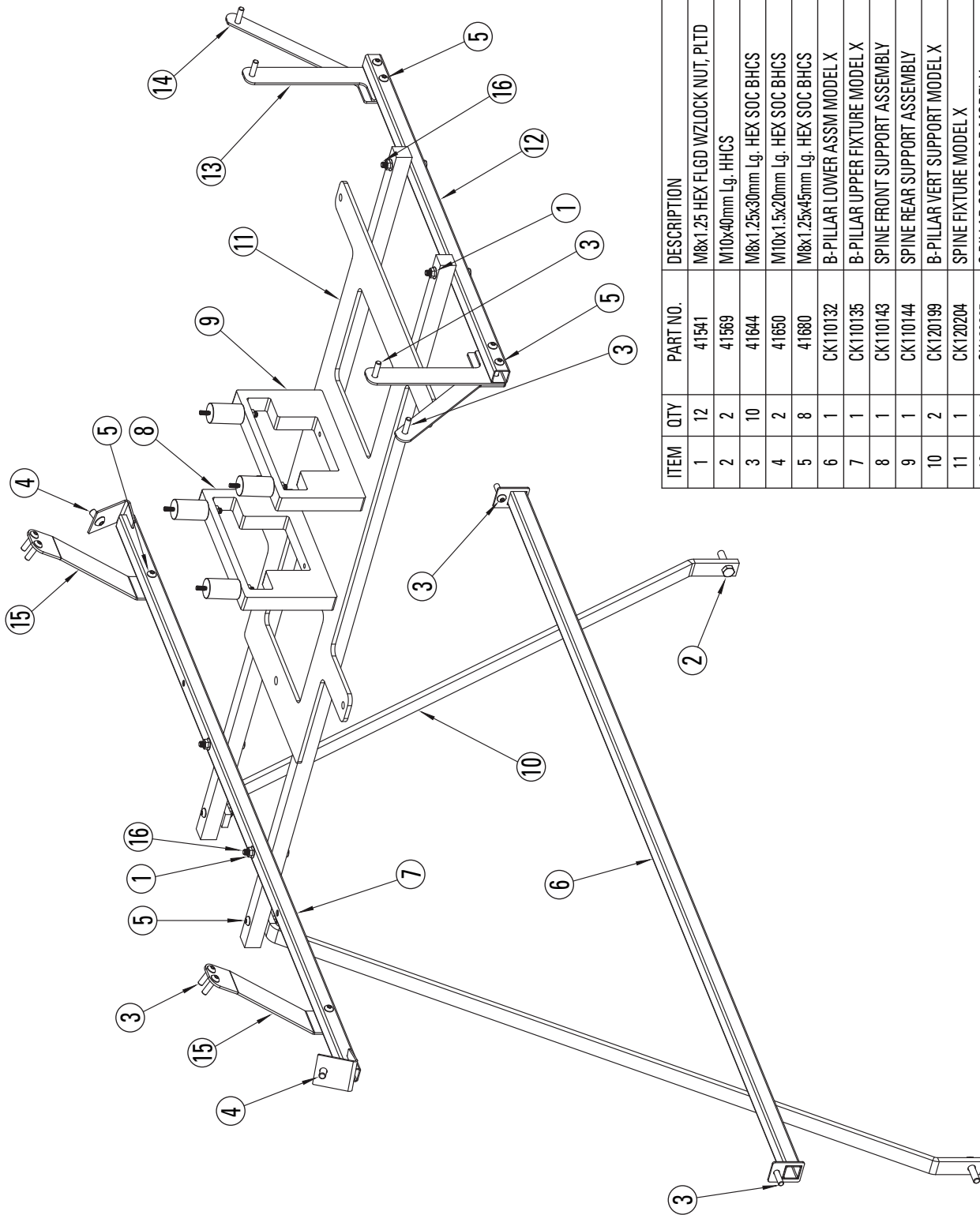

ITEM	QTY	PART NO.	DESCRIPTION
1	12	41541	M8x1.25 HEX FLGD WZLOCK NUT, PLTD
2	2	41569	M10x40mm Lg. HHCS
3	10	41644	M8x1.25x30mm Lg. HEX SOC BHCS
4	2	41650	M10x1.5x20mm Lg. HEX SOC BHCS
5	8	41680	M8x1.25x45mm Lg. HEX SOC BHCS
6	1	CK110132	B-PILLAR LOWER ASSM MODEL X
7	1	CK110135	B-PILLAR UPPER FIXTURE MODEL X
8	1	CK110143	SPINE FRONT SUPPORT ASSEMBLY
9	1	CK110144	SPINE REAR SUPPORT ASSEMBLY
10	2	CK120199	B-PILLAR VERT SUPPORT MODEL X
11	1	CK120204	SPINE FIXTURE MODEL X
12	1	CK120205	C PILLAR CROSS BAR MODEL X
13	2	CK120207	C-PILLAR ROOF SUPPORT STRAP
14	2	CK120208	C-PILLAR ROOF SUPPORT OUTER STRAP
15	2	CK120209	B-PILLAR ROOF SUPPORT STRAP
16	4	CK130080	M8-1.25x65 HHCS 8.8, ZINC PLATED



# Model X Measuring in Genesis

The Model X vehicle specification in the Chief Genesis application was generated directly from Tesla CAD data files. The specification represents the vehicle in a level position, when supported at least 8 points (2 front, 4 center, and 2 rear locations).

The Model X can be measured for inspection purposes when supported only in the 4 center section holding points. In this case, with a fully assembled vehicle, the front section measuring points may show 3-5mm of sag versus the level vehicle spec. Less sag will appear in the rear section.

To level out the sag from a fully assembled vehicle, front and rear fixtures can be built up to the holding points. The fixtures can then be raised using the turnbuckle adjustment detailed in the "Planning and Setup" section of manual IN20828, until the front and rear measuring points are level to the specification.

Always refer to OEM repair procedures for proper repair guidelines. **IMPORTANT** The Model X must not be subjected to pulling forces.

## Measuring from Fixtures

When replacing Spine in Model X, Upper Body Bar will be required.

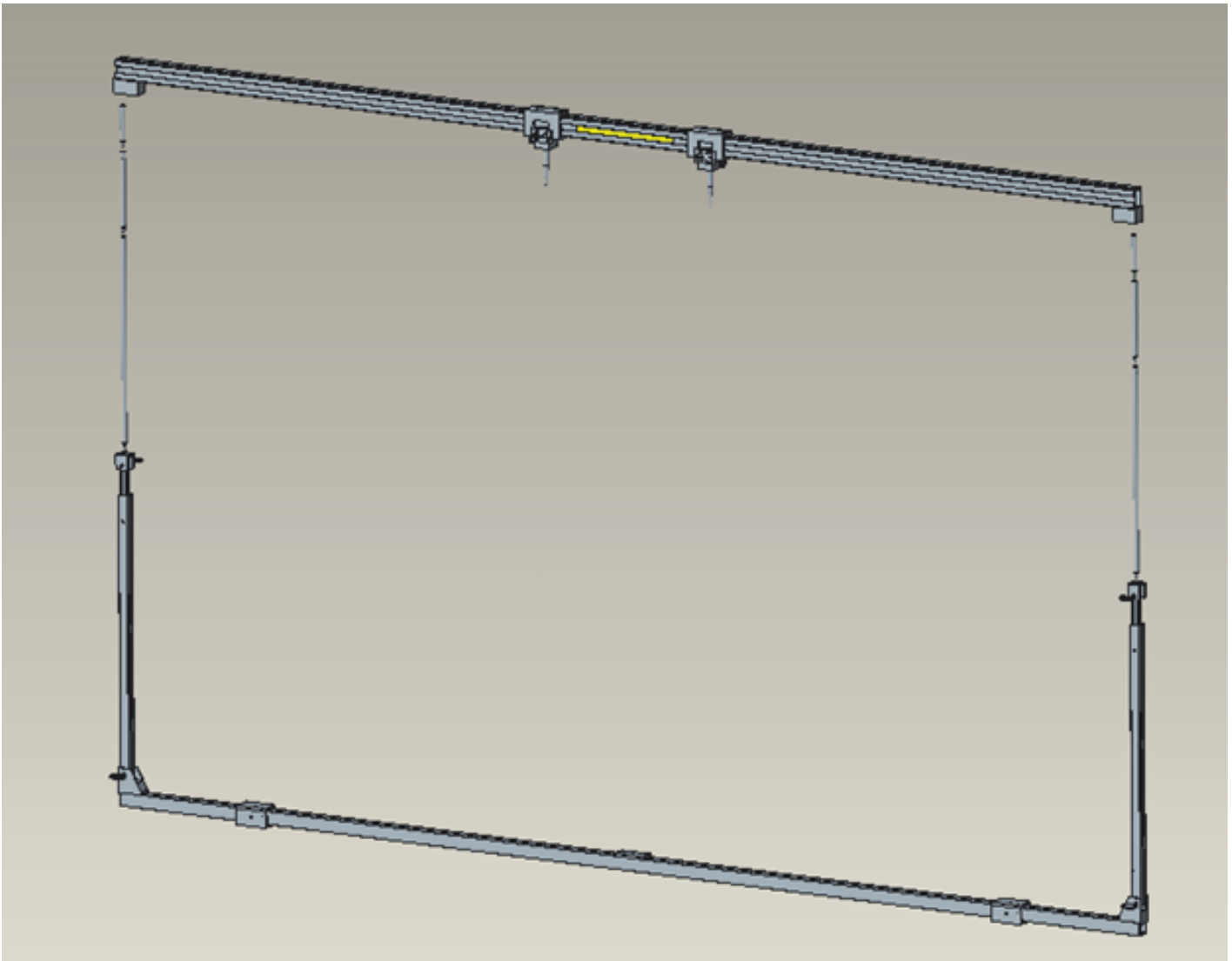



Place pointers of UBB in holes located in Fixture Plate using bolt hole cap 11mm.

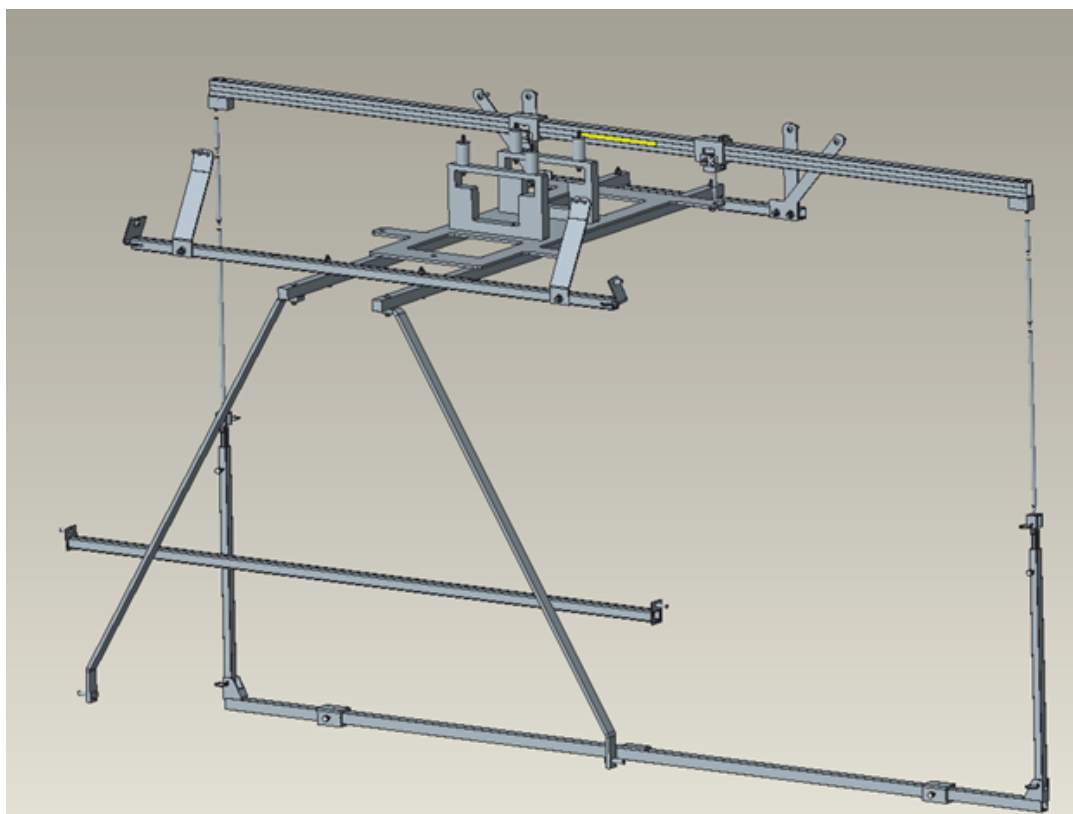
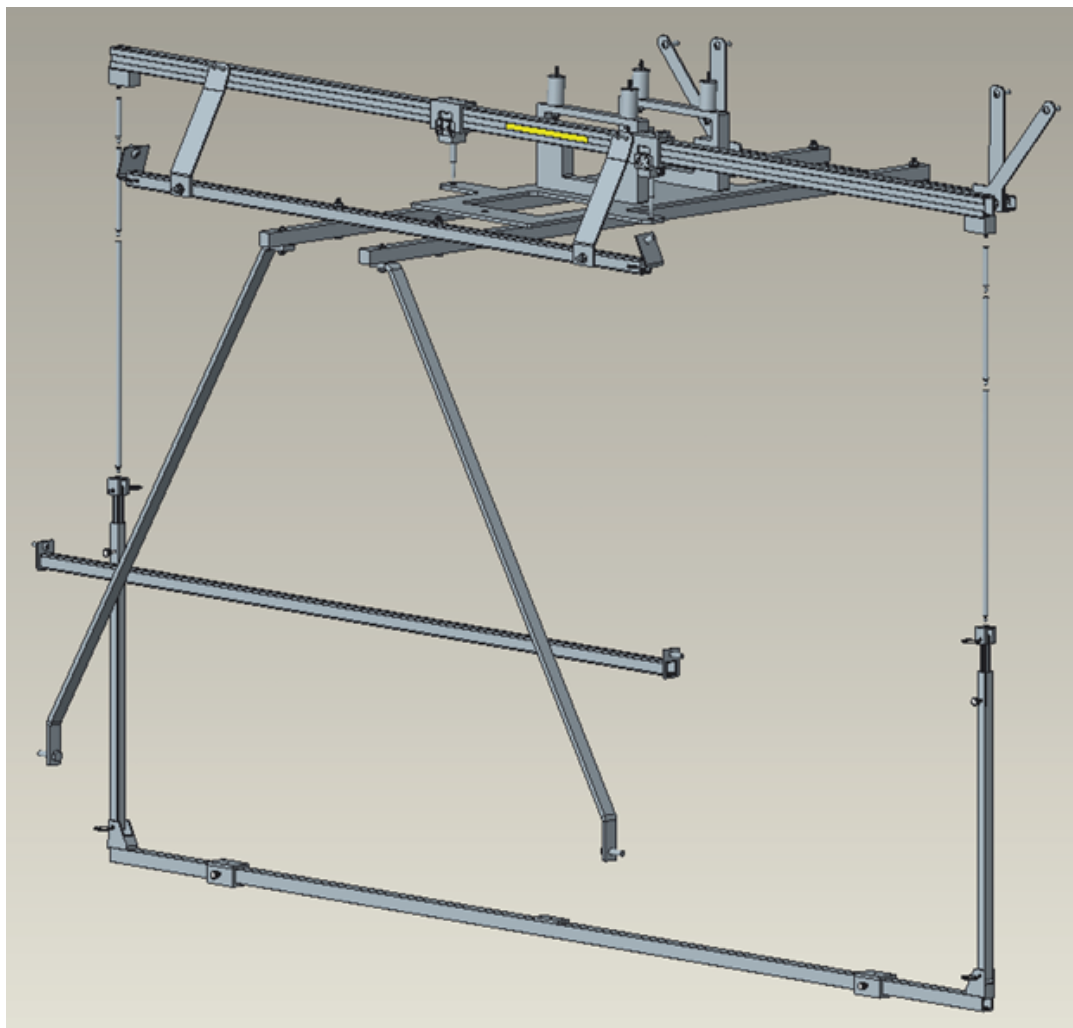

## NOTES

## NOTES



Chief Automotive Technologies  
996 Industrial Drive  
Madison, IN 47250  
Phone: 800-445-9262  
Fax: 866-275-0173



[www.chiefautomotive.com](http://www.chiefautomotive.com)

Chief reserves the right to alter product specifications  
and/or package components without notice.